

TOOL DEALS



\$359.95

Master Chain Repair Set BS70002

- Designed for drive chain replacement and repair
- Provides the ability to break, rivet and press drive chain master links
- Includes chain breaking and riveting set, chain extractor, link pliers and tensioner tool



\$149.95

Chain Installation Press Tool BS70008

- Designed to assemble the chain during repairs or replacement
- For the installation of the master link side plates into the rivet pins
- Includes rivet function to mushroom the hollow pin rivets
- For most 50 series chains and O-ring chains



\$299.95

Spoke Torque Wrench Set

Steel 22 Piece BS5503

- Dual-head spoke wrench enables tightening and removal of spokes in one piece
- Spoke torque tensioner applies correct and equal tension to the spokes (pre-set 4 ft.lbs)
- Sizes: 5.0, 5.6, 6.0, 6.2, 6.3, 6.5, 6.7, 6.9, 7.1, 7.4mm & Spline
- Spoke remover releases damaged or rusted spokes easily
- Simply tighten the spoke until you hear and feel a click which indicates that the spoke is adjusted correctly



\$349.95

Spoke Torque Wrench Set

Steel 12 Piece BS70009

- Enables tightening and removal of spokes in one piece
- The adjustable spoke torque wrench applies correct and equal tension to the spokes
- Includes adjustable torque wrench (2-10 Nm) & 11 steel interchangeable heads
- Sizes: 5.0, 5.6, 5.8, 6.0, 6.2, 6.3, 6.5, 6.7, 6.9, 7.1, 7.4mm & Spline drive
- Simply tighten the spoke until you hear and feel a click which indicates that the spoke is adjusted correctly



\$119.95

Professional Tyre Inflator

2" Dial Gauge BS70010

- Dual pressure analogue display, kPa and PSI
- Working pressure 0-700kPa (100psi)



BEARING SERVICE

\$69.95

Bearing Packer BS4326

- Simple and effective bearing packer
- Enclosed casing so grease stays in the tool cavity, not on your hands
- Clear casing allowing visual inspection
- Suits: Bearings up to 89mm (3 1/2")



BEARING PACKER

Bush Driver Sets

- Comprehensive kits specifically designed for removal and replacement of bearings and oil seals
- Features tapered cone bearing and seal driver tools, manufactured from aluminium for damage free bearing and oil seal replacement
- Available in Metric and SAE



BUSH DRIVERS



| Part No. | Description | Suits | Sizes | PRICE |
|----------|--------------|---------------|---|----------|
| BS9144 | 17 Piece Set | 10 - 42mm | Drive Handles: 11 x 105, 16 x 130, 20 x 142mm Bush Adapters: 10-42mm | \$114.95 |
| BS9145 | 19 Piece Set | 3/8" - 1 3/8" | Drive Handles: 11 x 105, 16 x 130, 20 x 142mm Bush Adapters: 3/8" - 1 3/8" | \$119.95 |

BRAKE SERVICE

\$229.95

Vacuum Pump & Brake Bleeder Kit BS5582

- Bleeds hydraulic brake and clutch systems - one-man operation
- Die cast pump body with gauge and accessory kit including three connector sizes and various adaptors



BRAKE PAD & BLEEDING

Disc Pad Brake Spreaders

- Compresses the brake pistons on most calipers during brake pad replacement
- Suits all front and some rear disc brake applications

| Part No. | Jaw Width | Jaw Thickness | Spread Capacity | PRICE |
|----------|-----------|---------------|-----------------|----------|
| BS9870 | 300mm | 3mm | 6.5 - 43.0mm | \$77.95 |
| BS9871 | 68mm | 3mm | 6.5 - 55.0mm | \$129.95 |



BRAKE SERVICE

\$15.95

Headlight & Brake Spring Hook 150mm BS0044

- Specially designed for removing and installing hard-to-reach headlight, exhaust and brake springs
- Easier and safer to use than pliers
- T-handle grip for comfortable easy use
- 30° shaft angle provides additional leverage



BRAKE OVERHAUL

\$57.95

Brake Piston Detaching Tool BS5800

- Extracts pistons from the caliper during service and overhaul
- Ratcheting handle holds position allowing hands to be free
- Suitable for caliper pistons with internal diameters of 20-54mm



CABLE SERVICE

\$8.95

Wire Retaining Tool BS1034

- Designed to firmly hold cables, wires and fasteners during removal and replacement
- Net diameter: 20mm
- Cable Length: 450mm



CABLE TOOLS

\$16.95

Cable Wire Lubrication Tool BS4531

- Designed to lubricate throttle and clutch cables
- Lubricating motorcycle cables prolongs service life and reduces risk of breakage
- Simple operation injects lubricant into cable housing



FLEXIBLE HOSE CLAMP NUT DRIVER

\$35.95

Sealing Ring Assembly Tool Set 4 Piece BS5810

- Tapered tool set for pulling o-rings or sleeves onto brake components and hydraulic systems without risk of damage
- Size range: 14.4-22.4mm



\$24.95

Flexible Hose Clamp Nut Driver 300mm BS2008

- Flexible shaft allows easy access to awkward locations during removal and installation of hose clamps
- Comfortable grip, high torque handle
- Hollow drive handle stores sockets and bits
- Contains: 4, 6, & 8mm sockets, 4mm Flat head bit and Phillips #2 bit



CHAIN & BELT SERVICE

CHAIN ADJUSTING C-HOOK WRENCH

\$60.95

Chain Adjusting C-Hook Wrench BS0353

- Specially designed for use with slotted retaining rings, such as motorcycle monoshock suspension and rear wheel hub's eccentric axle for chain elasticity
- Thin and adjustable hook enables access in confined areas (4mm)
- Size: 118-158mm



DRIVE CHAIN

\$264.95

Chain Breaking & Riveting Master Kit BS35101

- Forged hardened alloy steel body with three position handle suitable for left and right hand use
- Supplied with press plates, punches and anvils
- Suits: Chain sizes: #415, 420, 428, 520, 525, #30 (50), 532, 630 and 632



\$44.95

Chain Alignment Tool BS70007

- Enables quick and accurate chain alignment
- Designed for universal use, suitable for most motorcycles and ATV's
- Affix to the rear sprocket with alignment rod facing forward to align chain
- Suitable chain sizes 420 - 630mm

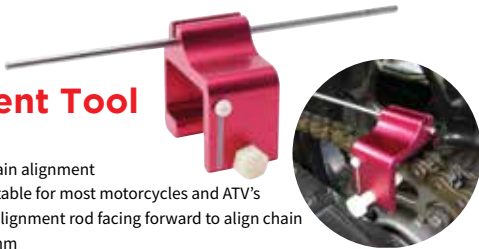

\$41.95

Chain Cleaning Brush BS9850

- Dual head chain cleaning brush
- Unique U shaped robust bristle design enables cleaning of three sides of the chain
- Long soft brush for more delicate cleaning
- Ideal for use in confined or tight space



CLUTCH & TRANSMISSION

CLUTCH & PULLEY LOCKING WRENCHES

\$148.95

Universal Pulley Holder Wrench Set BS3112

- Vice grip style locking wrench holds clutch hubs, flywheels, gears, pulley and sprockets during lock nut removal and installation
- Durable handle and adjustable locking design
- Five pairs of different size pins to suit common applications
- Jaw capacity: 140mm
- Pin working capacity: 22-145mm



CLUTCH & TRANSMISSION

FLYWHEEL PULLERS

Magneto Flywheel Pullers

- Threaded pullers designed to remove starter and magneto flywheels



BS2469

BS2444

BS2462

BS2461

VARIOUS OTHER STYLES AVAILABLE FROM BIKESERVICE

| Part No. | Size | Thread | PRICE | Part No. | Size | Thread | PRICE |
|----------|-------------|----------|---------|----------|------------|----------|---------|
| BS2461 | M24 x P1.5 | Internal | \$30.95 | BS2467 | M33 x P1.5 | Internal | \$45.95 |
| BS2462 | M26 x P1.0 | Internal | \$27.95 | BS2474 | M33 x P1.5 | External | \$29.95 |
| BS2443 | M27 x P1.0 | External | \$27.95 | BS2468 | M35 x P1.5 | Internal | \$53.95 |
| BS2444 | M27 X P1.25 | External | \$27.95 | BS2469 | M35 x P1.5 | Internal | \$38.95 |
| BS2484 | M28 x P1.0 | Internal | \$29.95 | BS2488 | M38 x P1.5 | Internal | \$67.95 |
| BS2463 | M30 x P1.5 | Internal | \$36.95 | BS2494 | M50 x P1.5 | Internal | \$79.95 |

\$54.95

6 in 1 Magneto Flywheel Puller BS9950

- Specially designed tool for the standard AC flywheel wheel ring
- Six sizes to fit most magneto flywheel threads
- Since some flywheels are the taper lock style, they can only be disengaged using this specialist tool
- Use with soft face hammer for quick removal from tapered shafts
- Sizes: M10 x 1.25 RH, M14 x 1.5 RH, M16 x 1.5 RH, M18 x 1.5 RH, M24 x 1.0 RH, M27 x 1.0 LH
- Threads: External



\$499.95

Magneto Flywheel Puller Set

Internal 16 Piece BS30015

- Features threaded pullers designed for fixed-point type magneto flywheels
- Chrome alloy steel ball tip on shaft to reduce friction stress during disassembly
- Sizes - M24 x 1.0 - M50 x 1.5
- 1/2" Sq. Dr. (21mm Hex)



\$499.95

Magneto Flywheel Puller Set

15 Piece BSB00391

- Features threaded pullers designed for fixed-point type magneto flywheels
- Chrome alloy steel ball tip on shaft to reduce friction stress during disassembly
- Sizes - M19 x 1.0 - M42 x 1.5
- 1/2" Sq. Dr. (21mm Hex)



COOLING SYSTEM SERVICE

COOLING SYSTEM & RADIATOR PRESSURE TEST SET

\$449.95

Cooling System & Radiator Pressure Test Set BS0244

- Hand operated pump builds and displays pressure quickly to locate leaks in cooling and radiator systems
- Dual scale pressure gauge (PSI / Bar) features 300mm hose and push-button pressure release valve
- Includes attachments to test both cooling system and radiator caps



ENGINE SERVICE

COMPRESSION TESTERS

\$399.95

Crankshaft Installation Kit BS30022

- Specialist Crankshaft installation tool kit
- Designed for installation of the crankshaft into the crank case
- Suitable for most single cylinder vertically split engines
- Manufactured from chrome molybdenum alloy steel for durability and long service life
- Includes 1 x installation pot, 1 x pot spacer, 1 x nut & bolt and 11 adapters: M7 x 1.0, M10 x 1.25, M12 x 1.25, M12 x 1.0, M12 x 1.25, M14 x 1.0, M16 x 1.0, M18 x 1.0, M14 x 1.5, M10 x 1.25, M22 x 1.0, M12 x 1.25

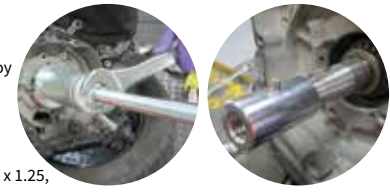

ELECTRICAL SYSTEM

HEAT SHRINK SET

\$24.95

Heat Shrink Tube Set 171 Piece BS1030

- RoHS compliant
- Shrink ratio: 2:1
- Shrink temp: 70°C - 110°C
- Operating temp: -55°C - 125°C



\$239.95

Cylinder Compression Test Kit BS8001

- Designed specifically for testing motorcycle and small engine compression
- Features a 70mm dual scale gauge (0-300PSI / 0-20kg/cm²) with chrome bezel and quick coupler fitting
- Supplied with three 12" hose adaptors featuring quick coupler attachments
- Compression tester and hose lengths are designed for optimal viewing alongside engine
- Covers most popular motorcycle and small engine plug sizes (16, 18, 21mm)
- Supplied in a protective metal case
- Thread sizes: M10 x 1.0, M12 x 1.25, M14 x 1.25



\$29.95

BMW Ignition Lead Removal Tool

(R, F, G, K, Series) BS12901

- Designed to release the spark plug high tension coil
- Simple and effective tool to eliminate the possibility of damage to the coil assembly during removal



\$23.95

Spark Plug Maintenance Kit

6 Piece BS1298

- Specially designed hole can adjust the gap width of the spark plug without pressuring the centre electrode
- Tapered edge sets spark plug gaps from 0.50 to 2.25mm (0.020" to 0.100")
- Five thin mini files designed for ignition points and electrode cleaning



\$311.95

Cylinder Leak Down Test Kit BS8002

- Checks the amount of cylinder leakage in 4-stroke engines
- The system will pressurise the cylinder to 60 PSI and register the total percentage of leakage past the rings, head gasket, intake and exhaust valves
- Gauge features pressure regulator and quick coupler connection
- Supplied with four 270mm flexible hose adaptors rated to 300PSI
- Speeds up troubleshooting & helps to isolate worn components
- Covers plug sizes 16, 18, 21mm plus M18 hose for vacuum pump
- Thread sizes: M10x1.0, M12x1.25, M14x1.25, M18x1.25
- Air input: 70-160 PSI



Thin Wall Spark Plug Sockets

- Extra thin wall deep socket designed to access narrow spark plug holes found on many motorcycles

| Part No. | Size | PRICE |
|----------|------|----------------|
| BS9132 | 14mm | \$19.95 |
| BS9133 | 16mm | \$19.95 |
| BS9134 | 18mm | \$20.95 |
| BS9135 | 21mm | \$20.95 |



ENGINE OVERHAUL

Piston Locating Tools

- Designed for visually indicating the relative crank shaft and piston position at top dead centre
- For camshaft timing in addition to the timing marks
- POM tip prevents piston damage

| Part No. | Thread | PRICE |
|----------|-------------|----------------|
| BS2250 | M10 x P1.0 | \$13.95 |
| BS2251 | M12 x P1.25 | \$14.95 |
| BS3074 | M14 x P1.25 | \$15.95 |



ENGINE SERVICE

ENGINE OVERHAUL

\$130.95

DUCATI TDC Crankshaft Locking Tool BS30008

- Specialised Ducati crankshaft TDC locking tool
- Designed to locate and hold the engine at Top Dead Centre (TDC)
- Ensures the crankshaft remains in a fixed position during repair or cam belt replacement
- Equivalent to OEM part number 88713.2011



\$43.95

DUCATI Crankshaft Turning Tool BS30010

- Specialised Ducati 2-point lug type crankshaft turning tool
- Ensures safe engine rotation during valve inspection and repairs
- Manufactured from chrome molybdenum alloy steel for durability and long service life
- Equivalent to OEM part number 88713.3824



\$33.95

Ducati Crank Shaft Turning Tool BS23050

- Enables rotation of the engine safely during valve clearance check or timing setting
- Made from chrome molybdenum alloy steel for durability and long service life
- Suits: all Ducatis from 1990-2011



\$48.95

DUCATI Camshaft Locking Pins (M5) BS30011

- Locks the camshafts during timing belt replacement and cylinder head servicing and repairs
- Size M5 x 0.8mm (x 4)
- Equivalent to OEM part number 887132009



\$37.95

DUCATI Camshaft Locking Pins (M6) BS30012

- Locks the camshafts during timing belt replacement and cylinder head servicing and repairs
- Size M6 x 1.0mm (x 2)
- Equivalent to OEM part number 887132257



\$32.95

DUCATI Camshaft Locking Pins (M8) BS30013

- Locks the camshafts during timing belt replacement, and cylinder head servicing and repairs
- Size M8 x 1.25mm (x 2)
- Equivalent to OEM part number 887132282



ENGINE SERVICE

ENGINE OVERHAUL

\$39.95

Ducati Alternator Cover Puller BS23021

- Twin-pull style puller used to remove the alternator cover from Ducati Motorcycles
- Eliminates the need for prying or impact tools to remove the cover
- Ideal tool for general inspections or for installing a lightweight flywheel
- Used with 14mm hex driver



\$94.95

Piston Pin Removal And Installation Tool BS30018

- Essential tool for removing and installing piston pins without damaging the piston
- Knurled aluminum handle provides a firm and comfortable grip
- Includes interchangeable adaptors
- Suitable for piston sizes from 40 to 100mm (1 5/8" to 4") with pin sizes from 12 to 25mm (1/2" to 1")
- Applications included all single-cylinder engines from 50cc to 600cc, and all 2, 3, and 4-cylinder models



\$215.95

Piston Ring Compressor BS3032

- The ideal compressor set for quick top end rebuilds or serious engine overhauls
- Supplied with piston ring pliers and swivel type compressor pliers
- Ratcheting plier function holds the piston ring in position for easy installation of the piston into the bore
- Suitable for piston rings 35mm - 111mm (1 3/8" - 4 3/8")



\$40.95

Piston Ring Plier BS3039

- Used to remove and install piston rings during engine overhaul
- Ratcheting function handle holds piston rings steady during removal and installation
- Suitable for piston rings: 35mm - 111mm (1 3/8" - 4 3/8")



\$87.95

Emergency Cam Chain Breaking & Riveting Tool Kit BS3550

- For emergency chain repairs only
- Compact tool kit for quick cam chain replacement
- Forged hardened alloy steel body and components
- Includes body, handle and push pins
- Suits chain plate quantity: 2x3, 3x4, 4x5



ENGINE SERVICE

ENGINE OVERHAUL

\$127.95

Valve Spring Compressor Kit 6 Piece BS9947

- For use during removal and servicing of engine valves and seals upon cylinder head or engine repair
- Adaptor sizes: 19, 23 and 25mm
- Jaw depth: 110mm
- Jaw capacity: 20-135mm



\$199.95

Crankcase Separator Tool Set BSB02300

- Simple and effective puller set to suit most two and four stroke engines that have a vertically split crankcase
- Adjustable puller legs allow for a multitude of bolt patterns
- Includes M6 / M8 mounting bolts with quick acting nut, forcing screw and three leg frame
- Spread: 50-240mm



STUD REMOVER AND INSTALLER TOOL

Stud Remover And Installer Tool

- Easily removes and installs studs without damage to threads
- Suitable for most popular thread stud sizes



| Part No. | Thread | Removal Tool | Install Tool | PRICE |
|----------|-------------|--------------|--------------|---------|
| BS2311 | M6 x P1.0 | BS2311A | BS2311B | \$36.95 |
| BS2312 | M8 x P1.25 | BS2312A | BS2312B | \$36.95 |
| BS2313 | M10 x P1.25 | BS2313A | BS2313B | \$36.95 |
| BS2314 | M10 x P1.5 | BS2314A | BS2314B | \$36.95 |



TAPPET ADJUSTING TOOL SET

\$88.95

Tappet Adjusting Tool Set BS2201

- Includes three sockets and three adjusters which are interchangeable to allow nine different combinations
- Hollow socket design provides access for adjuster making tappet adjustment an easy single operation
- Knurled edge provides a positive grip on adjusters
- Suitable for most motorcycles and ATVs with screw-type tappet adjustments
- Includes
 - 3 x hex wrenches
 - 2 x square adjusters
 - 1 x flat blade adjuster
- Hex wrenches: 8, 9, 10mm
- Square adjusters: 3, 4mm
- Flat adjuster: 4mm



FUEL & EXHAUST

CARBURETOR ADJUSTING DRIVERS

\$16.95

Carburetor Adjusting Driver

D Socket 165mm BS0059

- Ideal for air/fuel mixture screws in confined spaces
- Finger snap driver handle has been designed specifically to make sensitive carburetor adjustment effortless
- Tip: D type socket
- Overall Length: 165mm



\$245.95

Carburetor Adjusting Tool Set 9 Piece BS0058

- Designed for those hard-to-reach air/fuel mixture screws on most multi-cylinder motorcycles
- Special angled drive design assists in aligning the bit with the carburetor adjustment screw
- Includes Flat, Phillips, PH#2 and D-type bits



CARBURETOR SYNCHRONISER VACUUM GAUGE SET

\$419.95

Carburetor Synchroniser Vacuum Gauge Set BS8117

- Contains precision gauges, each with its own damping control 4 x 1200mm hose, clamps and fittings included
- Gauges are mounted to a portable heavy duty metal base for bench top use
- Suitable for multi carburetor balancing



GENERAL WORKSHOP

PICK & HOOK SET

Pick & Hook Sets

- Designed for easy removal of O-rings, split pins, seals and bushes in various mechanical applications
- Each hook and pick is made of stainless steel with durable plastic soft grip handle
- Set contains straight (awl), hook tool, 45° & 90° bent picks

| Part No. | Length | PRICE |
|----------|--------|---------|
| BS1234 | 162mm | \$21.95 |
| BS0230 | 214mm | \$27.95 |



GENERAL WORKSHOP

\$32.95

Seal Pick Set BS1235

- Quick and easy removal of o-ring and grease oil seals
- Special angled head provides easier access for removal than traditional tools
- Two piece set includes sizes 155mm & 195mm in length



SEAL PICK SET

Retractable Ratchet Tie Down

- Ideal for securing motorcycles, ATVs and jet skis etc. during storage or transportation
- All sets conform to standard AS/NZS 4380:2001



BS80032

BS80034

BS80019

BS80031

| Part No. | Strap Width | Strap Length | Lashing Capacity | Breaking Capacity | PRICE |
|----------|--------------|--------------|------------------|-------------------|----------|
| BS80019 | 47mm / 17/8" | 1.2m / 4ft | 250kg / 550lbs | 1360kg / 3000lbs | \$224.95 |
| BS80032 | 25mm / 1" | 1.8m / 6ft | 227kg / 500lbs | 680kg / 1500lbs | \$68.95 |
| BS80031 | 25mm / 1" | 2.4m / 8ft | 227kg / 500lbs | 680kg / 1500lbs | \$71.95 |
| BS80034 | 25mm / 1" | 4.5m / 15ft | 227kg / 500lbs | 680kg / 1500lbs | \$95.95 |

HAND TOOLS

\$34.95

Magnetic Parts Tray

Rectangle BS9404

- Useful storage tray with strong in-built magnet
- Ideal for storing and holding small parts, nuts, bolts and screws neatly and securely during dismantle and reassembly
- Strong magnets attach to all metal surfaces including hoists, scissor lifts and steel workbenches, even upside down
- Size: 240 x 140 x 30mm



PARTS TRAY

HAND TOOLS

\$99.95

T-Handle Set 8 Piece 300mm BSBP003

- Sizes: 6, 8, 10, 12, 13, 14, 17, 19mm
- 300mm



T-HANDLES

\$28.95

Vacuum And Fuel Hose Removal Pliers BS20001

- Designed to remove stubborn fuel or vacuum hoses promptly and safely without damaging components
- Features sharpened "V" jaw for secure grip and spring return for easy operation
- Suits: 4-13mm hose



KEYS & BITS

\$40.95

Torx Key Set Long 9 Piece BS9101

- Supplied with magnetiser to assist in the fitment and removal of fasteners
- Supplied in a hinged storage holder with magnetiser attached
- Style: Torx (Tx-Star) - Long
- Sizes: T10, T15, T20, T25, T27, T30, T40, T45, T50



\$41.95

Hex Key Set Long 9 Piece BS9103

- Supplied with magnetiser to assist in the fitment and removal of fasteners
- Ball end allows improved access to application and up to 25° working angle for increased speed and ease of entry
- Sizes: 1.5, 2, 2.5, 3, 4, 5, 6, 8, 10mm



TOOL KITS

\$92.95

Personal Tool Pack BS9728

- Contains 1/4" Sq. Dr. ratchet and a selection of multi driver sockets and drive bits
- Fits metric and SAE 6 point, 12 point, TX-Star, Square, 30% round off, Spline and Ribe nuts
- See website for full contents list



HAND TOOLS

\$99.95

Personal Tool Pack

34 Piece **BS9725**

- Convenient tool carrying pack designed for metric motorcycles
- Contains a selection of hex sockets, drive bits, open-end wrenches and pliers
- Fits metric and SAE 6 point, 12 point, TX-Star, square, 30% round off, spline and ribe nuts
- See website for full contents list



TOOL KITS

MASTER MECHANICS TOOL KIT

\$649.95

Master Mechanics Tool Kit 110 Piece **BS9839**

- A comprehensive tool set with all tools and tool sizes specially selected for motorcycle service and maintenance
- Includes a comprehensive selection of quality Bikeservice screwdrivers, Allen keys, ratchets, sockets and bit sets
- Size : 440mm (W) x 240mm (D) x 230mm (H)
- Weight: 15kgs (includes tools)



STEERING & SUSPENSION

C-HOOK WRENCHES

C-Hook Wrenches

- Specially designed for use with slotted retaining rings
- Thin hook can access confined areas in motorcycle steering and suspension (4mm thickness)
- Manufactured from chrome vanadium hardened steel



| Part No. | Size | PRICE |
|---------------|------------------------|----------------|
| BS0350 | 19-51mm (3/4" - 2") | \$33.95 |
| BS0351 | 32-76mm (1 1/4" - 3") | \$47.95 |
| BS0352 | 51-120mm (2" - 4 3/4") | \$69.95 |



FORK & REAR SHOCK SERVICE

\$206.95

Harley Fork Cap Installation Kit **BS4120**

- Specialist Harley Davidson kit
- Enables the easy installation of fork caps on forks with a large amount of spring preload
- Reduces the risk of damage to the fork caps during installation
- Suitable for most 39mm and 41mm Harley Davidson fork applications
- Includes 2 x adaptors, 1 x 39mm socket, 1 x 41mm socket, and 1 x jackscrew



\$36.95

Fork Oil Level Gauge 60ml Capacity **BS41500**

- Tool for checking and adjusting the oil level on conventional and single chamber cartridge forks
- Graduated steel tube with adjustable level setting ring measures oil level from 0-300mm in 5mm increments



STEERING & SUSPENSION

AXLE ALIGNMENT TOOLS

Ducati Axle Alignment Tool

- Essential tools for aligning the front axle on Ducati motorcycles
- Correctly aligns the axle with the notch on the fork bottom during axle tightening
- Alignment of the front axle is critical to allow access to the compression damping screw for suspension adjustment



| Part No. | Suits | Size | Application | PRICE |
|----------------|-------------|----------------|--|----------------|
| BS55301 | 25mm Showa | 25mm I.D. Axle | Ducati 748, 749, 916, 996, 998, 999, ST2, ST3, ST4, 800SS and 1000SS | \$31.95 |
| BS55302 | 25mm Ohlins | 25mm I.D. Axle | Ducati Hypermotard 796 and 1100 | \$31.95 |
| BS55303 | 30mm Ohlins | 30mm I.D. Axle | Ducati Panigale 848, 1198 and 1199, Streetfighter 848, Multistrada 1200 and Diavel | \$31.95 |

\$19.95

Fork Seal Cleaning Set 5 Piece **BS4210**

- Designed to easily remove dirt and other debris trapped between the fork seal and tube
- 5 piece set



\$309.95

Fork Front Vice **BS5000**

- The fork vice is designed to hold round or awkward shaped items including forks, shocks, pistons
- Simply bolt vice onto your work area using the pre-drilled mounting holes
- Unique V shape jaws are covered with thick rubber pads to ensure items are held in place without damage
- Max opening : 100mm



STEERING & SUSPENSION

FORK & REAR SHOCK SERVICE

\$77.95

Damper Rod Fork Tool BS50013

- Designed for the servicing of most Kayaba and Showa inverted forks
- Sizes 41, 43, 46 & 47mm
- Equivalent to OEM part number Honda 07PMB-KZ4010A and Yamaha YM-01423



\$39.95 EACH

Shock Seal Head Setting Tools

- Designed for easy installation of shock seal head assemblies

| Part No. | Size |
|----------|---------|
| BS50014 | 33-36mm |
| BS50015 | 40-50mm |
| BS50016 | 50mm |



\$129.95

Fork Spring Compressor BSD00355

- Fork Spring Compressor with innovative locking mechanism
- Consists of fork spring compressor and damper rod holding plate
- Applicable size: 10, 12, 14mm
- Essential tool for servicing or changing springs in upside down forks



FORK CAP SOCKETS

\$33.95 EACH

Front Fork Cap Sockets

- Specially designed sockets to remove octagonal front fork caps
- Use with 3/8" Sq. Dr. or 19mm spanner



| Part No. | Size | Suits |
|----------|----------------|--|
| BS4030 | 45mm Octagonal | SHOWA BPF with 45mm octagonal fork cap |
| BS4031 | 46mm Octagonal | SHOWA suspension with 46mm octagonal fork caps Application: Honda CRF 250R (2010), Suzuki RM125/250 and replaces Suzuki P/No. 09941-53620 |
| BS4032 | 49mm Octagonal | KYB suspension with 49mm octagonal fork caps Application: Honda CRF 450R, Yamaha YZ125/250, YZ250F/450F, Kawasaki KC450F |
| BS4033 | 50mm Octagonal | SHOWA suspension with 50mm octagonal fork cap Application: Honda CRF 250R/450R, CRF 250X/450X, Suzuki RM125/250, RMZ 250/450, Kawasaki KC250F and replaces Suzuki P/No. 09941-53630 |

STEERING & SUSPENSION

FORK CAP SOCKETS

\$17.95

Twin Chamber Front Fork Socket BS4051

- Specially designed socket to remove the compression body from the cartridge on KYB twin chamber forks
- Use with 3/8" Sq. Dr. or 19mm spanner
- Size: 36mm Octagonal
- Suits: KYB twin chamber forks with 36mm octagonal fork caps
- Application: YAMAHA YZ series and P/No. YM-01500



\$111.95

DUCATI Fork Cap Socket Sachs BS50009

- Enables the easy removal and installation of fork caps
- Manufactured from hard plastic to the risk of damage to the fork caps during installation
- Size - 10 sided (50mm across the flats), 1/2" drive or 27mm spanner
- Suitable for Ducati applications fitted with Sachs type forks



\$111.95

DUCATI Fork Cap Socket OHLINS 39mm BSD50006

- Features 8-Pin with O-ring design to protect the fork cap during removal and installation
- T-6 aluminium with steel pins for durability and long service life
- 8 x 3.5mm pins, 39mm PCD, 1/2" drive or 24mm spanner



\$111.95

DUCATI Fork Cap Socket OHLINS Mechatronics 42mm BSD50007

- Features 8-Pin with O-ring design to protect the fork cap during removal and installation
- T-6 Aluminium with steel pins for durability and long service life
- 8 x 2.5mm pins, 42mm PCD, 1/2" drive or 24mm spanner



\$111.95

DUCATI Fork Cap Socket OHLINS Marzocchi 46mm BSD50008

- Features 6-Pin with O-ring design to protect the fork cap during removal and installation
- T-6 aluminium with steel pins for durability and long service life
- 6 x 3.0mm pins, 46mm PCD, 1/2" drive or 24mm spanner
- Suitable for Ducati applications fitted with Marzocchi type forks



\$199.95

Fork Seal Driver Universal BSD00356

- Universal Fork Seal Driver Tool specifically designed for the replacement fork seals and dust covers
- Manufactured from Glass-Filled Nylon to avoid damaging the fork surface
- Unique design with spring loaded fingers that lock securely around the fork plunger
- Suitable for fork diameters of Ø30mm - Ø50mm



STEERING & SUSPENSION

STEERING BEARING OUTER RACE REMOVAL TOOL

\$77.95

Steering Bearing Outer Race Remover

320mm (12 1/2") **BS4201**

- Enables easy outer race removal while avoiding tube damage
- Four contact points ensure even distribution of force
- Size: 35-55mm (1 3/8"-2 3/16") tube dia.



STEERING STEM SERVICE

\$24.95

Steering Stem Nut Tool

Ducati 3/8" Sq. Drive **BS4019**

- Ensures correct torque is achieved to the steering head compression nut
- Rubber cushion design eliminates damage to the steering stem nut



\$169.95

Steering Tube Bearing Installer Tool Kit **BS50017**

- Simple and safe approach to steering tube bearing installation
- Includes installation drift and five adaptors
- Ideal solution to reduce risk of damaging components
- Extension rod - 290mm
- Adaptor sizes: 24, 26, 28, 30mm
- Extension rod - BSD09894 also available
- Enables an additional 500mm of travel



\$206.95

Steering Tube Bearing Puller Kit **BS9892**

- Press frame puller system used to remove the lower steering stem bearing
- Features extra thin jaws for entry between triple clamp and bearing
- Rod extensions mean tool can be used on multiple sizes of steering stems
- Bearing Separator: 30-46mm
- Reach: 240-280mm
- Ratchet Wrench: 17, 19mm



\$299.95

Steering Head Bearing Installer Kit **BSD98940**

- Vital tool with improved design to correctly install steering head bearings
- Features new quick acting nut, conical plate and tapered step ring for fast and accurate use
- A hassle free system reducing the possibility of damage during the bearing installation process
- Suits: bearing diameter sizes: 41-55mm

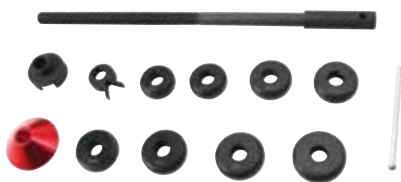

TYRE & WHEEL

FRONT WHEEL SPINDLE REMOVAL TOOL

\$28.95

Front Wheel Spindle Removal Tool **BS5530**

- Multi-fit wheel removal tool to suit female hexagonal axles
- Designed to fit most spindles during front wheel removal
- 4 sizes in 1 tool to cover most modern motorcycle applications
- Knurled centre ring for hand use to start thread
- 3/8" Sq. Dr.
- Sizes: 17, 19, 22, 24mm (6 Point)



TYRE CHANGING TOOLS

\$35.95

Valve Core Torque Tool **BS3949**

- Ensures accurate torquing of tyre valves reducing the potential for leakage
- Solid plastic grip handle
- Pre-set to 4 in.lbs



Tyre Levers

- Professional quality tyre lever manufactured from hardened and tempered drop forged chrome vanadium steel
- Designed for motorcycle tyre replacement



| Part No. | Size | PRICE | Part No. | Size | PRICE |
|----------|-------|----------------|----------|-------|----------------|
| BS5603 | 200mm | \$13.95 | BS5612 | 350mm | \$49.95 |
| BS9953 | 280mm | \$32.95 | BS5604 | 400mm | \$29.95 |

\$68.95

Valve Stem Removal Tool **BSE00470**

- An essential tool which offers a safe, powerful approach in removal or installation of the tyre valve
- Ideal for difficult to reach valves on scooter or motorcycle wheels
- Adjustable supporting point suits various rim widths



TYRE PRESSURE & TREAD DEPTH

\$99.95

Tyre Pressure Dial Gauge **BS80086**

- Professional tyre pressure gauge with protective rubber bumper
- Incorporates thread depth measuring tool
- Includes braided steel hose, swivel chuck and pressure release button
- Working pressure to 5 Bar (70 PSI)



TYRE & WHEEL

WHEEL BALANCING & SPOKE TENSION

\$499.95

Wheel Turning & Balancing Stand BS5501

- All in one motorcycle wheel balancing stand with adjustable legs and molded all-round reading level to ensure extremely accurate and reliable wheel balancing
- Adjustable centring coned rods on ball bearings
- Complete with dial gauge for accurately checking wheel runout
- Capacity: 455mm (18")
- Maximum width: 370mm (14 1/2")



TYRE & WHEEL

WHEEL REMOVAL TOOLS

Wheel Nut Sockets

- Prevents damage to lock nuts and wheel spindle threads due to over tightening



| Part No. | Size | Max. Torque | Style | Applications | PRICE |
|----------|------|-------------|----------|--|---------|
| BS5550 | 41mm | 280-320Nm | 6 Point | 748, 916, 996, 998. Superbike 848, Hypermotard 798, 1100, Monster 796, 1100, and others with 41 or 46mm hex rear wheel nut | \$71.95 |
| | 46mm | | | | |
| BS5551 | 30mm | 280-320Nm | 6 Point | Superbike 1098, 1198, 1199 Panigale, Streetfighter 1098, Multistrada 1200 and Diavel Carbon | \$98.95 |
| | 55mm | | 12 Point | | |
| BS5552 | 26mm | 280-320Nm | 12 Point | MV Agusta F4 all model and Brutale all models | \$98.95 |
| | 56mm | | | | |
| BS5553 | 28mm | 280-320Nm | 6 Point | 748, 916, 996, 998, Superbike 848, Hypermotard 798, 1100, Monster 696, 796, 1100, and any Ducati with a 25mm front axle | \$69.95 |
| | 30mm | | | | |
| BS700012 | 60mm | - | 6 Point | KTM wheel nut socket for front and rear axles 1290 Super Duke R (2014 - 2016), Super Duke GT (2016), Super Duke R | \$99.95 |

• HOT PRICE • WHILE STOCKS LAST • HOT PRICE • WHILE STOCKS LAST •

\$94.95

Universal Joint T-Handle Set BSBP007

- Long reach T-handles with universal joint drive ideal for accessing confined fasteners
- Sliding beam handle can be set in three positions

Contents

| Part No. | Sq. Drive | Length |
|----------|----------------|--------|
| BS80018 | 1/4" Sq. Drive | 375mm |
| BS80017 | 3/8" Sq. Drive | 420mm |
| BS80016 | 1/2" Sq. Drive | 500mm |



\$27.95

Starter Flywheel Puller 3/8" Sq. Dr BS2460

- Threaded puller removes the starter flywheel from the engine crankshaft
- Use with 3/8" Sq. Dr. or 19mm hex and 30mm hex spanner
- Length: 110mm, Size: M24 x 1.0, Thread: Internal



\$25.95

Starter Gear Nut Wrench 1/2" Sq. Dr BS2493

- Removes the starter gear from the engine crankshaft
- The offset opening engages the nut without engaging the shaft
- Depth: 65mm
- Size: 29mm I.D. x 40mm O.D. x 4 point (5.8mm)



\$29.95

T-Handle Speed Ring Set BS1700

- Assists T-Handle socket alignment and allows the T-Handle shaft to rotate freely during removal and fitment of fasteners
- Increases the speed of T-handle socket use and eliminates friction between the metal shaft and the operators hand during rotation



\$16.95

Cable Replacement Tool Tachometer BS1501

- Wiring harness tool for tachometer cable replacement
- Simply connect the cable and retrieve the substitute cable
- Ergonomic moulded handle provide a positive grip during operation
- Thread: M12 x 1.0
- Cable Length: 1100mm



\$10.95

Oxygen Sensor Socket 11/16in 3/8" Sq. Dr BS4224

- Specialist tool designed for the removal and installation of oxygen sensors in motorcycle applications
- Manufactured from durable chrome molybdenum steel for superior strength and longevity



\$89.95

Multi-Function Ratchet Wrench Set BS80056

- Features six interchangeable ratchet mechanisms
- Includes three universal joints and safety lock extensions in 1/4", 3/4" and 1/2" Sq. Drive
- Ratchet handle length: 200mm



ENGINE SERVICE

ENGINE OVERHAUL

\$129.95

Harley-Davidson Gudgeon Pin Remover & Installer Tool BS30019

- Harley Davidson Gudgeon (Wrist) pin removal and installation tool
- Designed to hold the piston secure whilst removing the gudgeon pin
- Manufactured from lightweight aluminium and chrome molybdenum alloy steel



TYRE & WHEEL

WHEEL REMOVAL TOOL

\$99.95

Ducati Wheel Nut Socket 30 & 55mm BSE05551

- Suits: Superbike 1098, 1198, 1199 Panigale, Streetfighter 1098, Multistrada 1200 and Diavel Carbon
- Can be used with air tools



ELECTRICAL SYSTEM

STAINLESS SCISSORS

\$29.50

Stainless Scissors BS9314

- Suitable for cutting cables, hoses, pipes and thin metal sheet
- Hardened stainless steel blades
- Angle ground blade reduces slip when cutting
- Ergonomic grip handle
- Spring loaded operation



CLUTCH & TRANSMISSION

CLUTCH SPRING COMPRESSOR

\$125.95

Harley-Davidson Clutch Spring Compressor BS67500

- Essential tool used to compress the clutch spring for removal and installation of the retainer ring during clutch replacement
- 5/16" UNF internal thread for all XL models (1991-2005)
- 7/16" UNF external thread for all Big Twin (1990-1997)
- Includes all Buell (1991-2003) and Buell Blast (except 1125R)



FLYWHEEL PULLER SET

\$299.95

Magneto Flywheel Puller Set

External 14 Piece BS30014

- Features threaded pullers designed for fixed-point type magneto flywheels
- Chrome alloy steel ball tip on shaft to reduce friction stress during disassembly
- Sizes - M19 x 1.0 - M33 x 1.5
- 1/2" Sq. Dr. (21mm Hex)

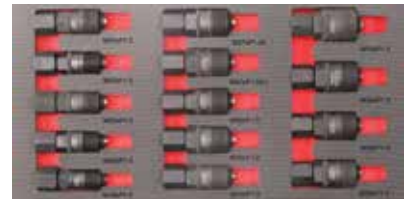

BEARING SERVICE

BEARING EXTRACTOR

\$529.95

NEW PRODUCT

Universal Bearing Extractor Kit BS80010

- Comprehensive blind bearing puller kit designed to remove Motorcycle wheel bearings in blind holes without damage.
- Split collet adaptor and slide hammer design for ease of use.
- Suitable for bearing bore diameters 8 - 32mm (5/16" - 1 1/4")
- Dual-purpose slide hammer and knock head



Distributed by:



"We supply more than just Bearings"
Laverton North & North Geelong
9314 2555 | 5278 9789
www.rollingbearingswest.com.au

0462-24 Prices valid 1 October to 31 December 2024. Prices include GST. Please refer to tridon.com.au/Bikeservice for additional product information. As participating stores are independent businesses, they reserve the right to set their own selling prices. Pricing throughout this publication is the recommended trade price and may vary from store to store. Every effort has been made to ensure stocks are available at the time of printing. Should any item not be in stock on placement of orders, stores will endeavour to procure those published items. Product images are for illustration purposes only. Produced by Tridon Australia Pty Ltd ACN 001 398 698 ABN 90 001 398 698